

### 8 Install Hard Drives/Carriers

- A Remove the screw securing the drive carrier to the chassis.
- B Slide the carrier away from the two chassis sidewall pins and remove.

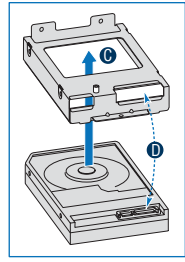

- C Insert hard drive into the carrier.
- D Make sure connector-end of drive goes into the carrier as shown.

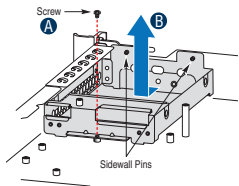
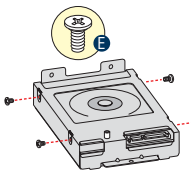

- E Attach the hard drive to the carrier with four screws as shown.
- F Re-install the hard drive/carrier assembly into the chassis.

Repeat these steps for each installed hard drive

### 9 Cabling Hard Drives

- A Attach a SATA power cable to each hard drive as shown.
- B Attach a SATA data cable to each hard drive as shown.
- C Use the cable clips provided with your chassis to maintain proper air flow.

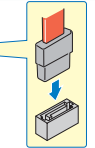
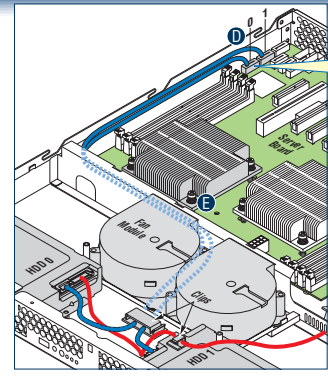
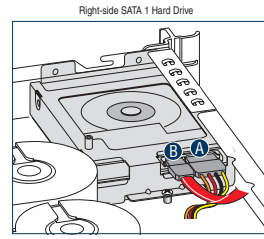
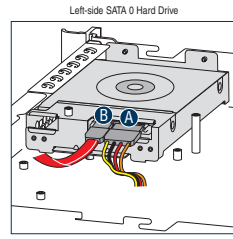
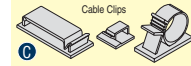

- D Attach each SATA data cable to its matching server board SATA connector as shown.
- E Route cables to server board as shown.

**CAUTION** It is critical that you connect the SATA data cables correctly from the hard drives to your server board.  
Example: HDD 0 to server board SATA 0.  
Failure to do so may result in data loss.

### 10 Install and Cable Optical Device (optional)

- A Before installing the optical device, you must remove the slimline bezel. Remove by rocking back and forth to break the attach points. Once removed, this bezel cannot be used again.

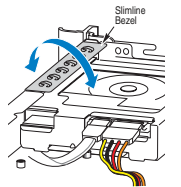

- B Attach the LEFT bracket to the optical device as shown.
- C Attach the RIGHT bracket to the optical device.

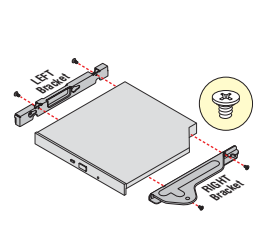

- D Insert optical device assembly into front panel opening.
- E Attach optical device tray to chassis standoff as shown.
- F Connect data ribbon cable to optical device and server board SATA connector as shown.
- G Connect power cable.

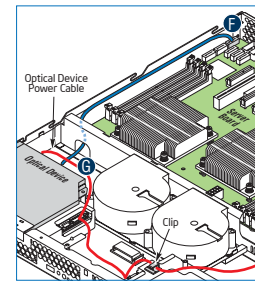
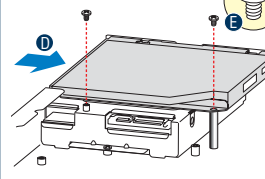

### 11 Install PCI Add-in Card(s)

- A Remove filler panel from the add-in card slot.
- B Insert add-in card until it seats in the riser connector.
- C Secure add-in card with screw as shown.

**CAUTION:** Observe normal ESD precautions when installing add-in cards.

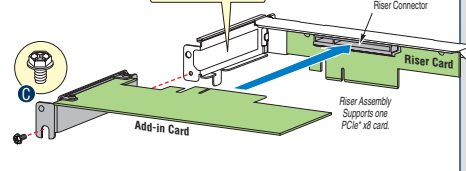

### 12 Install PCI Add-in Card Riser Assembly

- A Align the riser card with the server board riser socket.

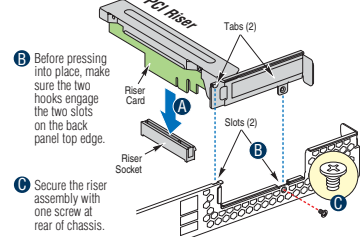

### 13 Install Processor Air Duct

Install processor air duct as shown.  
Use care to avoid pinching system cables.

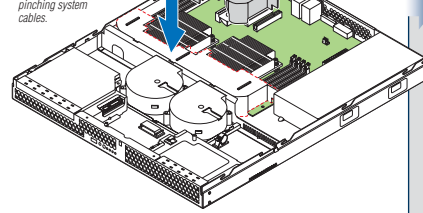

### 14 Install the Top Cover

- A Place cover onto chassis and slide forward.
- B Install two screws at front.
- C Attach with one screw at rear.

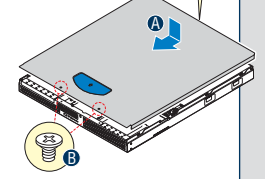

### 15 Install Rack Handles

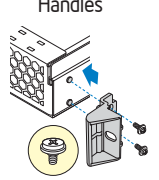

Install Rail Kit (optional)  
See the documentation that came with your selected rail kit for installation instructions.

### 16 Finishing Up

Before installing your operating system, you must finish your system installation and connect back panel I/O connectors and AC power.

- Make sure you have replaced the system cover.
- Connect your keyboard, mouse, video and other I/O cables/devices as shown. Then connect the AC power cord.

**CAUTION:** This unit must be operated with the TOP COVER installed to ensure proper cooling.

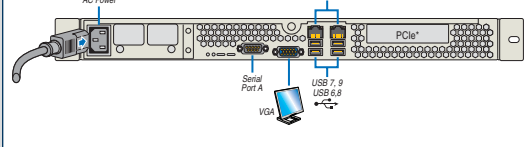

### 17 Install Software • BIOS, Drivers, and Operating System

- A. **Confirm BIOS Version:** Look on the Server/System Management screen in the BIOS Setup Utility to determine the installed BIOS version. Compare this to the versions at <http://support.intel.com/support/motherboards/server/S5500BC/>. If new versions are available, update the BIOS on your server. See the User Guide on the Intel® Server Deployment Toolkit 3.0 CD for update instructions.
- B. **Configure your RAID Controller:** Use the instructions provided with the RAID controller.
- C. **Install your Operating System:** Use the instructions provided with the RAID controller and with the operating system.
- D. **Install Operating System Drivers:** With the operating system running, insert the Intel® Server Deployment Toolkit 3.0 CD. If using a Microsoft® Windows® operating system, the Express Installer will automatically allow you to select the appropriate drivers to install. On other operating systems, browse the CD folders to locate and install the drivers.

Additional reference documents available at: <http://support.intel.com>

Document Type	Content
Technical Product Specification	In-depth technical information
Spares and Configuration Guide	Supported accessories and spares list
Tested Hardware and Operating System List	Tested peripherals and operating systems list
Tested Memory List	Tested memory list
Tested Processor List	Supported processors list
Software and Drivers	Up-to-date firmware, driver and utility information

## Reference

### Front Panel Controls and Indicators (shown with bezel removed)

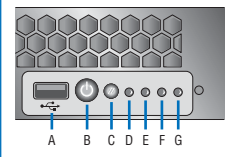

- A USB 2.0 Port
- B Power Button
- C Status LED
- D Power LED
- E HDD Activity
- F NIC1
- G NIC2

Optional Accessories/Spares and Order Codes	Order Code
400 W Power Supply	FRU1400WPS
Chassis Blower and Fan Kit	FRU1400PWS
Fixed Chassis Product Maintenance Kit	FRU1400PMKIT
PCIe (LP) Riser Card	AUX1PCIERISER
AXXSATA0VDROM	AXXSATA0VDROM
Tool-less Rail Kit	AXXRACKRAL
Cable Management Arm	AXXRACKCARM

A complete list of accessories and spares can be found at: <http://support.intel.com>

### Server Board S5500BC Component Layout

See your Intel® Server Board S5500BC User's Guide for expanded component and connection information.

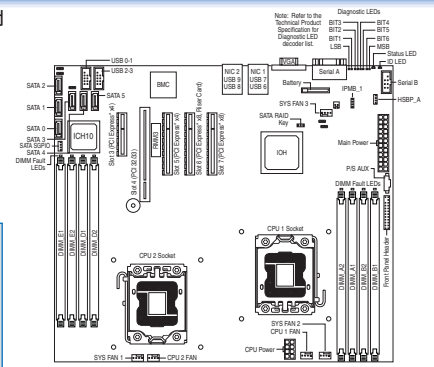

### Platform Cabling Diagram

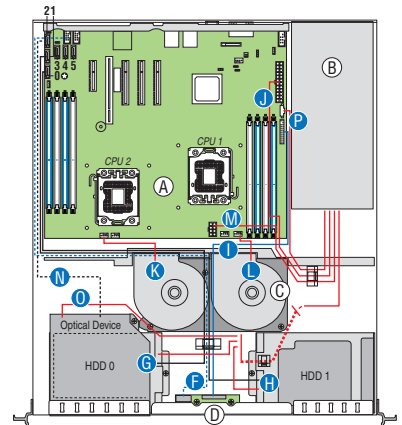

- A Server Board
- B Power Supply
- C Fan Module
- D Front Panel Board
- E Front Panel USB
- F HDD 0 to Server Board SATA 0
- G HDD 1 to Server Board SATA 1
- H Front Panel
- I Power to Server Board (Main)
- J Front Panel Power ... left fan
- K Fan Module Power ... right fan
- L Optical Device Data Cable
- M Power to Server Board (CPU)
- N Optical Device Power
- O Optical Device Power
- P Auxiliary Signals for the Power Supply

Server Board SATA Connector Legend  
Begin cable connectors at the SATA-0 location.